

# External Drain X01



X01-04-000

## Features

- Fully Automatic Float Operated
- No Electrical Connections
- Easily Installed
- Internal Pilot Operated
- Quick-Disconnected Clamp Ring for Easy Bowl Removal when Servicing
- Transparent Bowl with Metal Bowl Guard Standard

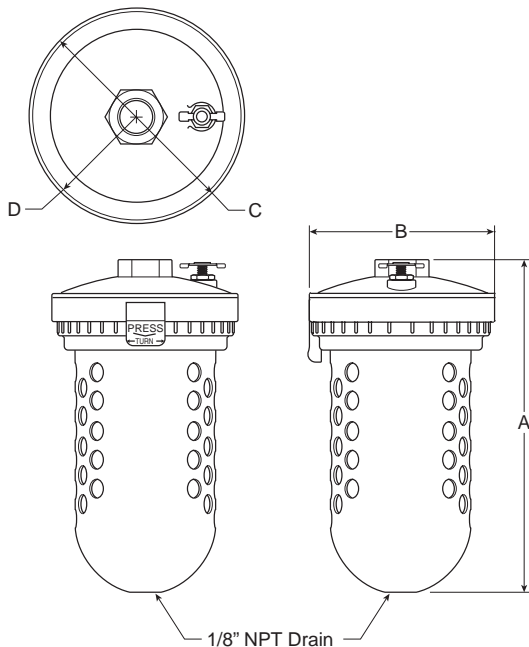

## Dimensions

Models	Inches (mm)	A	B	C	D
Standard Unit X01-04-000		8.58 (218)	4.76 (121)	4.76 (121)	2.36 (60)

## Specifications

Drain Rate	150 GPH @ 100 PSIG (570 l/h @ 6.9 bar)		
Maximum Supply Pressure	Plastic Bowl	150 PSIG (10.3 bar)	
	Metal Bowl	200 PSIG (13.8 bar)	
Operating Temperature	Plastic Bowl	32° to 125°F (0° to 52°C)	
	Metal Bowl	32° to 150°F (0° to 65.5°C)	
Port Size	NPT / BSPP-G		1/2
Weight	4.6 lb. (2.1 kg)		

## Materials of Construction

Body	Zinc
Float Assembly	Plastic with Stainless Steel Internals

## Replacement Kits

Bowl Guard, Metal (for Plastic Bowl)	GRP-95-808
Bowl –	
Metal, Drain Seat	FRP-95-630
Plastic with Drain Seat and Metal Bowl Guard	XRP-95-746
Clamp Ring Assembly	GRP-96-404
Drain, Over Center Float Drain Assembly	XRP-96-244
Drain, Over Center Float Drain Assembly – Rebuild Kit	DRP-95-141
Drain Seat Assembly	GRP-96-002
O-ring, Bowl –	
Fluorocarbon (10 per kit)	GRP-95-942
Bowl, Nitrile (10 per kit)	GRP-95-256

## Typical Installations

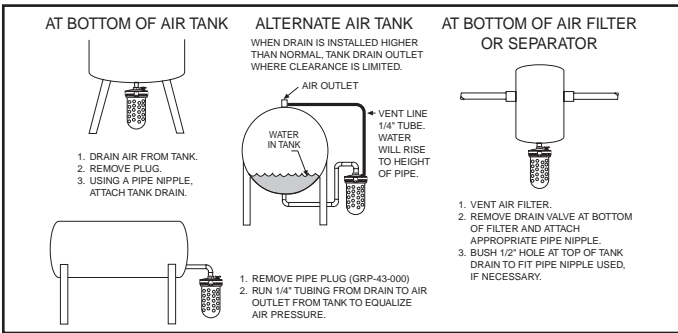

## External Drain

As liquid contaminants collect in the bowl, they raise a closed-cell molded float. When the liquid level reaches a given point, the float triggers a mechanism, which pilots line pressure against a large-area diaphragm, which snaps open the drain valve. The contaminants are discharged from the drain orifice at line pressure. As the liquid level falls, the pilot valve closes, line pressure against the diaphragm returns to atmosphere and the drain valve snaps closed.

B

Filters, Regulators, Lubricators

# External Drain X02 / XB3

 = "Most Popular"

B

Filters, Regulators, Lubricators



X02-04-000

XB3-04-M00

### Features

- Available in NPT and BSPP-G Ports
- The Manual Override Allows Drainage at Any Time Without Waiting
- Use of the Manual Override Does Not Interfere with the Normal Operation of the Drain
- To Assist in Compliance with EPA Regulations, a 1/8" Pipe Thread Allows the Liquid Discharge to be Piped Away. The X02 Has No Manual Override for the Automatic Drain.

### Specifications

Drain Rate	80 GPH @ 100 PSIG (300 l/h @ 6.9 bar)	
Maximum Supply Pressure	Plastic Bowl	150 PSIG (10.3 bar)
	Metal Bowl	200 PSIG (13.8 bar)
Operating Temperature	Plastic Bowl	32° to 125°F (0° to 52°C)
	Metal Bowl	32° to 150°F (0° to 65.5°C)
Port Size	NPT / BSPP-G 1/2	
Weight	XB3	1.42 lb. (0.6 kg)
	X02	1.26 lb. (0.6 kg)

### Materials of Construction

Body	Zinc
Float Assembly	Plastic with Stainless Steel Internals
Manual Override	Brass

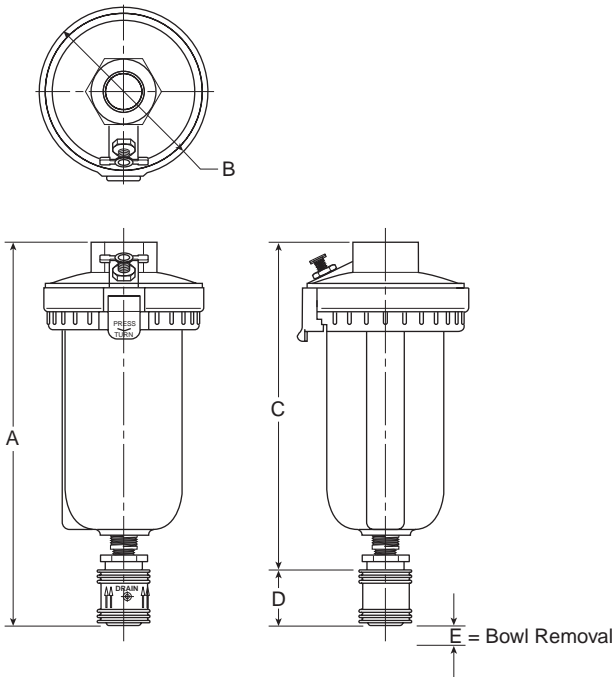

### Dimensions

Models	Inches (mm)	A	B	C	D	E
Standard Unit XB3-04-000		7.00 (179)	3.06 (78)	6.00 (152)	1.00 (25)	1.66 (42)
Standard Unit X02-04-F00		5.87 (149)	3.06 (78)	— —	— —	2.88 (73)
Metal Bowl XB3-04-M00		7.50 (190.5)	3.06 (78)	6.50 (165)	1.00 (25)	1.66 (42)
Metal Bowl X02-04-FM0		5.87 (149)	3.06 (78)	— —	— —	2.88 (73)



 = "Most Popular"

B

Filters, Regulators, Lubricators

External Drain

Wilkerson drains are designed to remove liquid oil and water contaminants from compressed air systems automatically.

Liquid contaminants collected in the bowl cause the float mechanism to rise. When the liquid reaches a specific level the float triggers a mechanism which pilots line pressure against a large-area piston. This action causes the drain orifice to open and evacuate the liquid and particulate contaminants. As the liquid level falls the pilot valve closes, line pressure against the piston returns to atmosphere and the drain valve snaps closed.

Wilkerson's XB3 model automatic drain includes the manual override. The manual override option allows for drainage at times when waiting for the system to drain automatically is not desirable.

Replacement Bowl Kits

- Bowl Guard, Metal (for Plastic Bowls) ..... GRP-95-846
- Metal Bowl –
  - Automatic Float Drain ..... GRP-96-007
  - Brass Petcock ..... GRP-95-539
  - Sight Gauge, Brass Petcock ..... LRP-95-673
- Plastic Bowl –
  - Flex Tip Drain ..... FRP-95-017
  - Plastic Petcock Drain ..... LRP-96-543
- Plastic Bowl, Metal Bowl Guard –
  - Automatic Float Drain ..... GRP-95-845
  - Flex Tip Drain ..... FRP-95-847

Accessories

- Auto Float Drain –
  - Fluorocarbon ..... GRP-95-981
- Drain, Manual Override For Auto Float Drains –
  - with 1/8 NPT Port ..... GRP-96-001
  - (Use with GRP-95-981 shown above. Order seperately)
- Manual Drain, Flex-Tip ..... FRP-95-610



# External Piston Drain X51

 = "Most Popular"

B

Filters, Regulators, Lubricators



X51-02-0000

### Features

- Automatically Drains Liquid Water from Compressed Air Receiver
- Drains Every Time System Pressure Decays (20 PSIG)

### Specifications

Maximum Supply Pressure	200 PSIG (13.8 bar)	
Minimum Supply Pressure	30 PSIG (2.1 bar)	
Minimum Differential Pressure Required	20 PSIG (1.4 bar)	
Operating Temperature	32° to 150°F (0° to 65.5°C)	
Port Size	NPT / BSPP-G	1/4
Weight	lb. (kg)	.8 (.36)

### Materials of Construction

Body	Aluminum
Bottom Cap	Plastic
Check Valve Ball	Chrome Alloy Steel
Piston	Brass
Seals	Fluorocarbon
Springs	Steel

### Replacement Kits

Maintenance Kit .....	XRP-95-511
Piston .....	XRP-95-512

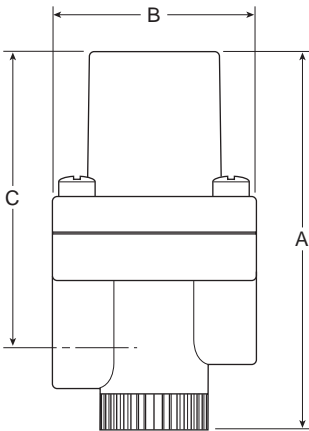

### Dimensions

Models	Inches (mm)	A	B	C
Standard Unit X51-02-0000		3.81 (96.8)	2.11 (53.6)	2.93 (74.4)

### Standard Acceptable Installation (X51 Mounted at Lowest Point in System)

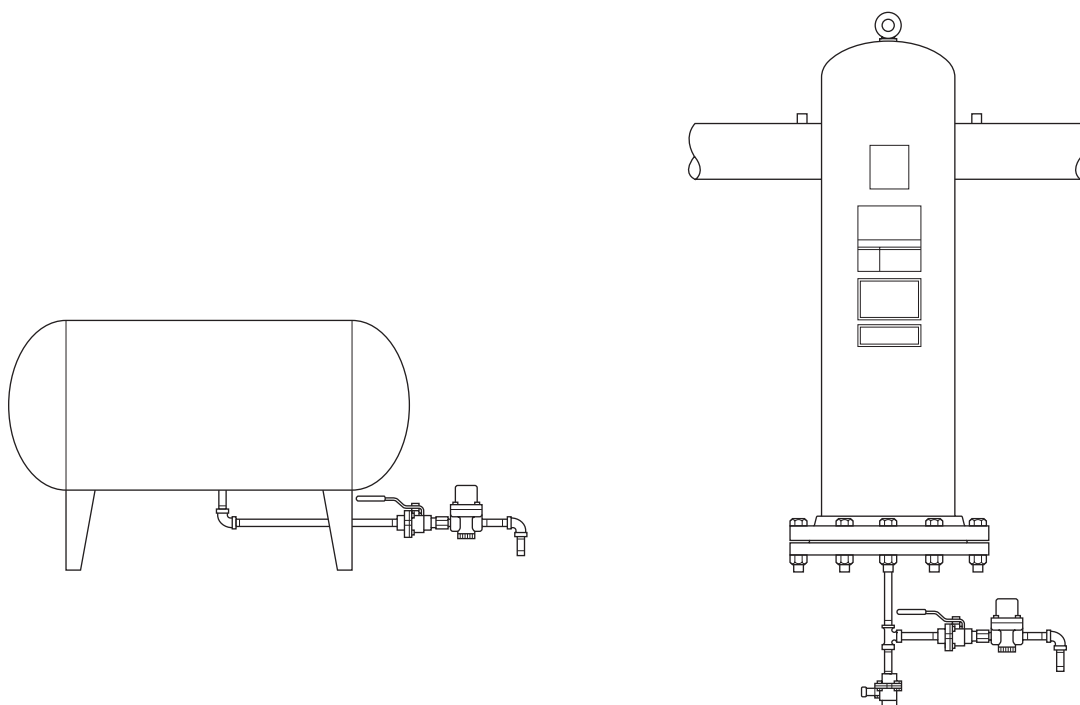
**B**

Filters, Regulators, Lubricators

### Unacceptable Installation (X51 Installed in Piping Above Lowest Point)

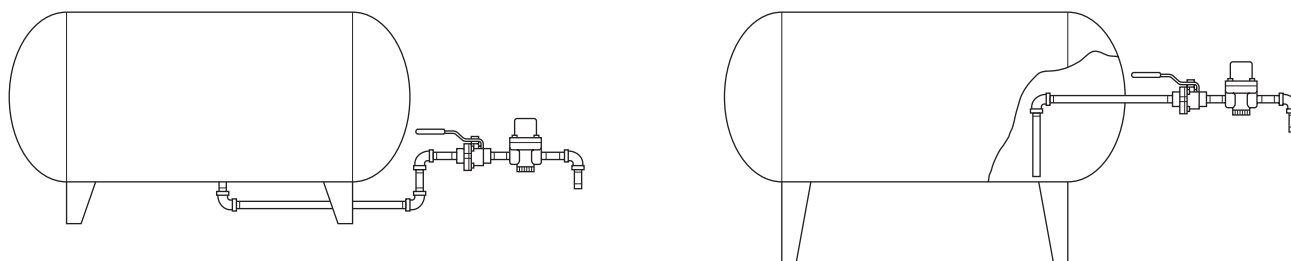

### Proper Installation of Remote Pilot (X51 Installed Above Lowest Point)

