

Square Drive Hydraulic Torque Wrenches

▼ From left to right: S3000, S6000, S1500



Simplicity

- 360° click-on, multi-position reaction arm
- Push button square drive release for quickly reversing the square drive for tightening or loosening
- Fine tooth ratchet prevents tool “lock-on”
- Single 360° hydraulic swivel manifold, complete with screw lock couplings, increases wrench and hose maneuverability.

Design

- Compact, high-strength uni-body construction for a small operating radius
- Robust design with minimal parts enables easy on-site maintenance without special tools
- Lightweight, ergonomic design for easy handling and an easy fit, even in applications where access is limited
- Optimised strength-to-weight ratio
- Fast operation due to the large nut rotation per wrench cycle (35 degree rotation angle) and rapid return stroke.

Reliability

- All wrenches are nickel-plated for excellent corrosion protection and improved durability in harsh environments.

Accuracy

- Constant torque output provides high accuracy across the full stroke
- Uni-body construction ensures accuracy by reducing internal deflections.

Rigid Steel Design

The *Professional* Square Drive Solution



S-Series, Square Drive Wrenches

This product range has been designed using state-of-the-art CAD techniques to bring you the most advanced square drive torque wrench on the market. To ensure that the tools you buy meet our own exacting requirements, during the design process every prototype was put through finite element stress analysis, photo-elastic modeling, rigorous cyclic testing and strain gauging.



TSP - Pro Series Swivel

Featuring Tilt & Swivel technology the TSP provides 360° X-axis rotation and 160° Y-axis rotation.

How to Order

Order as an accessory which can be fitted to existing S-Series wrenches.

Factory fitted to new S-Series wrenches: Suffix the wrench model number with "-P" e.g.: **S1500-P**.

Page: 9



Torque Wrench Hoses

Use Enerpac THQ-700 Series torque wrench hoses with S-Series torque wrenches to ensure the integrity of your hydraulic system.

6 m long, 2 hoses	THQ-706T
12 m long, 2 hoses	THQ-712T

Double-Acting Square Drive Hydraulic Torque Wrenches

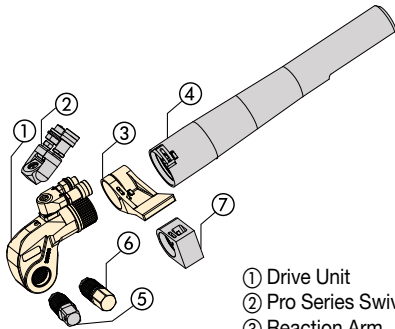

- ① Drive Unit
- ② Pro Series Swivel
- ③ Reaction Arm
- ④ Extended Reaction Arm

Select the Right Torque

250%

Choose your Enerpac Torque Wrench using the untightening rule of thumb: Loosening torque equals about 250% of tightening torque.

- ⑤ Square Drive
- ⑥ Allen Drive
- ⑦ Short Reaction Arm

S Series



Maximum Torque at 700 bar:

34.079 Nm

Square Drive Range:

3/4 - 2 1/2 inch

Nose Radius:

25,0 - 63,5 mm

Maximum Operating Pressure:

700 bar

* TORQUE WRENCH SELECTION (based on socket size range)

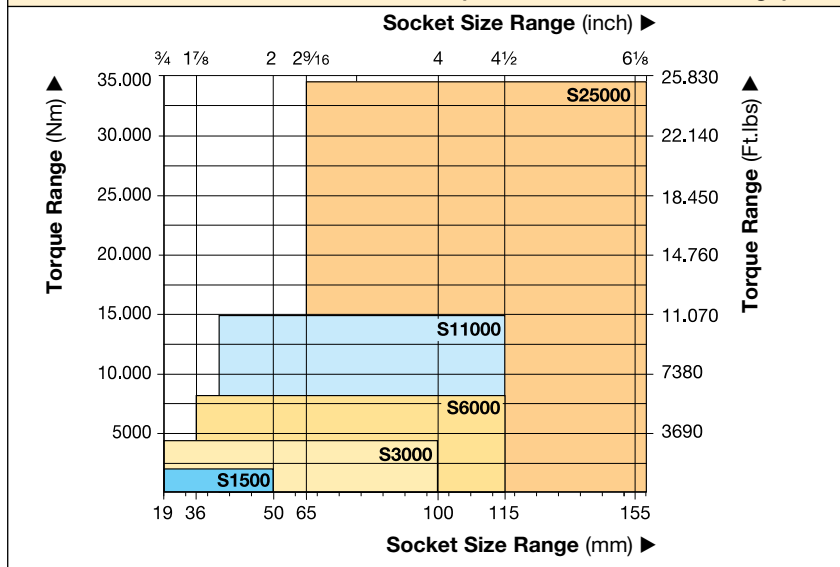

* Additional socket sizes available upon request.

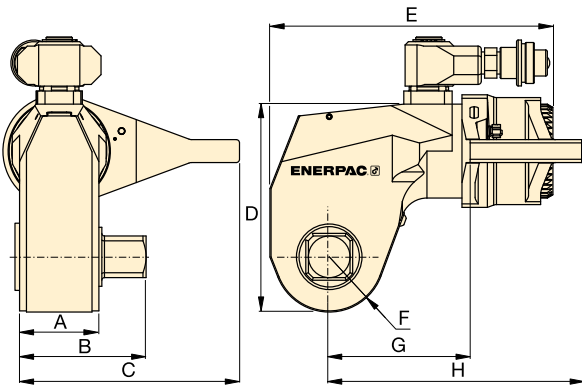

The rigid steel design of S-Series torque wrenches guarantee durability, reliability and safety. These wrenches can be powered by the portable ZU4T-Series pumps.





Torque Wrench and Pump Selection Matrix

For optimum speed and performance see the torque wrench and pump matrix.

Page: 30



Maximum Torque at 700 bar		Square Drive		Torque Wrench Model Nr.	Dimensions (mm)								Weight (kg)
		Size (inch)	Model No. (included with wrench)		A	B	C	D	E	F	G	H	
Nm	(Ft.lbs)												
1898	1400	3/4"	SD15-012	S1500	39	63	110	95	136	25,0	69	119	2,7
4339	3200	1"	SD30-100	S3000	48	77	134	126	172	33,0	90	159	5,0
8144	6010	1 1/2"	SD60-108	S6000	57	90	179	162	201	42,0	112	187	8,5
14.914	11.000	1 1/2"	SD110-108	S11000	71	111	196	185	226	49,5	132	227	15,0
34.079	25.140	2 1/2"	SD250-208	S25000	87	143	244	240	292	63,5	182	292	31,0

See "Yellow Pages" section for torque conversions.

To order a S-series wrench fitted with the TSP swivel, suffix the model number with "-P". e.g., S1500-P.

SDA-Series, Allen Key Drives

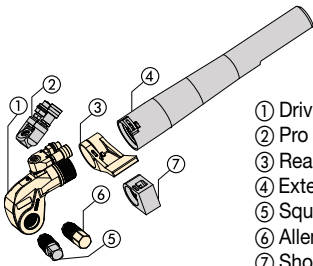

- ① Drive Unit
- ② Pro Series Swivel
- ③ Reaction Arm
- ④ Extended Reaction Arm
- ⑤ Square Drive
- ⑥ Allen Drive
- ⑦ Short Reaction Arm

Maximum Torque at 700 bar:

34.079 Nm

Square Drive Range:

3/4 - 2 1/2 inch



Hexagon Size Allen Drive:

14 - 85 mm

For
S
Series

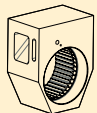
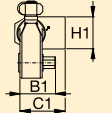

▼ SELECTION CHART

TORQUE WRENCH	OPTIONAL ALLEN DRIVES, IMPERIAL				OPTIONAL ALLEN DRIVES, METRIC				SHORT REACTION ARM FOR ALLEN DRIVES		
											
Model Number	Hexagon Size (inch)	Maximum Torque (Nm)	Model Number	Dim. B1 (mm)	Hexagon Size (mm)	Maximum Torque (Nm)	Model Number	Dim. B1 (mm)	Model Number	Dimensions (mm)	
S1500 (1898 Nm)	1/2	481	SDA15-008	66	14	644	SDA15-14	66	SRA15	67,5	65
	5/8	935	SDA15-010	67	17	1152	SDA15-17	68			
	3/4	1619	SDA15-012	71	19	1606	SDA15-19	70			
	7/8	1897	SDA15-014	74	22	1897	SDA15-22	73			
	1	1897	SDA15-100	77	24	1897	SDA15-24	74			
S3000 (4339 Nm)	5/8	935	SDA30-010	77	17	1152	SDA30-17	77	SRA30	80,0	74
	3/4	1619	SDA30-012	80	19	1606	SDA30-19	79			
	7/8	2568	SDA30-014	83	22	2486	SDA30-22	82			
	1	3828	SDA30-100	86	24	3232	SDA30-24	84			
	1 1/8	4336	SDA30-102	88	27	4336	SDA30-27	85			
	1 1/4	4336	SDA30-104	89	30	4336	SDA30-30	87			
	–	–	–	–	32	4336	SDA30-32	88			
S6000 (8144 Nm)	5/8	935	SDA60-010	85	17	1152	SDA60-17	86	SRA60	91,5	89
	3/4	1619	SDA60-012	89	19	1606	SDA60-19	88			
	7/8	2568	SDA60-014	92	22	2486	SDA60-22	91			
	1	3828	SDA60-100	95	24	3232	SDA60-24	93			
	1 1/8	5454	SDA60-102	97	27	4600	SDA60-27	94			
	1 1/4	7480	SDA60-104	98	30	6308	SDA60-30	96			
	–	–	–	–	32	7656	SDA60-32	97			
S11000 (14.911 Nm)	1 1/4	7480	SDA110-104	115	30	6308	SDA110-30	112	SRA110	127,5	106
	1 3/8	9953	SDA110-106	117	32	7656	SDA110-32	114			
	1 1/2	12.920	SDA110-108	118	36	10.894	SDA110-36	117			
	1 5/8	14.905	SDA110-110	122	41	14.905	SDA110-41	121			
	1 3/4	14.905	SDA110-112	125	46	14.905	SDA110-46	127			
S25000 (34.079 Nm)	1 1/2	12.920	SDA250-108	141	36	10.894	SDA250-36	140	SRA250	158,5	135
	1 5/8	16.423	SDA250-110	145	41	16.098	SDA250-41	144			
	1 3/4	20.508	SDA250-112	148	46	22.730	SDA250-46	148			
	1 7/8	25.230	SDA250-114	149	50	29.194	SDA250-50	151			
	2	30.617	SDA250-200	151	55	34.079	SDA250-55	154			
	2 1/4	34.079	SDA250-204	154	60	34.079	SDA250-60	158			
	–	–	–	–	65	34.079	SDA250-65	161			
	–	–	–	–	70	34.079	SDA250-70	164			
	–	–	–	–	75	34.079	SDA250-75	168			
	–	–	–	–	85	34.079	SDA250-85	175			

Accessories for S-Series Torque Wrenches

TSP-Series, Pro Series Swivels

- Featuring Tilt and Swivel technology
- 360° X-axis and 160° Y-axis rotation
- Increases tool fit in restricted access areas
- Simplifies hose placement.

**TSP
RTE
SRS
Series**

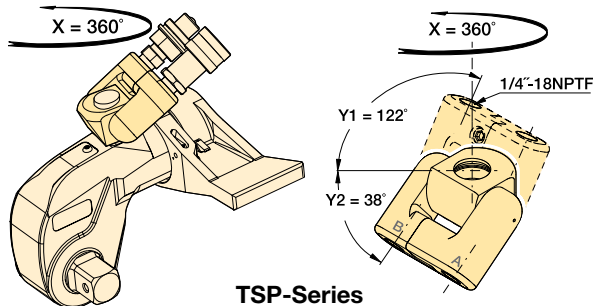

TSP-Series

For Torque Wrench Model Number	Model Number	Maximum Pressure (bar)	 (kg)
S1500, S3000	TSP100	700	0,2
S6000, S11000, S25000	TSP200	700	0,2

To order an S-series wrench fitted with the TSP swivel, add suffix "P" to the model number. Example: **S1500-P**. TSP-swivel does not include couplers.

RTE-Series, Reaction Tube Extensions

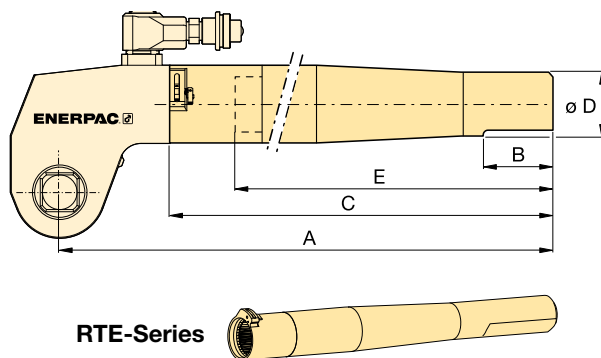

RTE-Series

- Full torque rated
- Increases tool fit in restricted access areas.

For Torque Wrench Model Number	Model Number	Dimensions (mm)					 (kg)*
		A	B	C	D	E	
S1500	RTE15	706	152	636	58	600	4,6
S3000	RTE30	733	152	647	57	600	5,5
S6000	RTE60	747	152	659	65	600	7,7
S11000	RTE110	769	152	675	76	600	11,2
S25000	RTE250	813	152	685	100	600	17,3

* Weights indicated are for the accessories only and do not include the wrench.

SRS-Series, Extended Reaction Arms

- Lightweight interchangeable design.

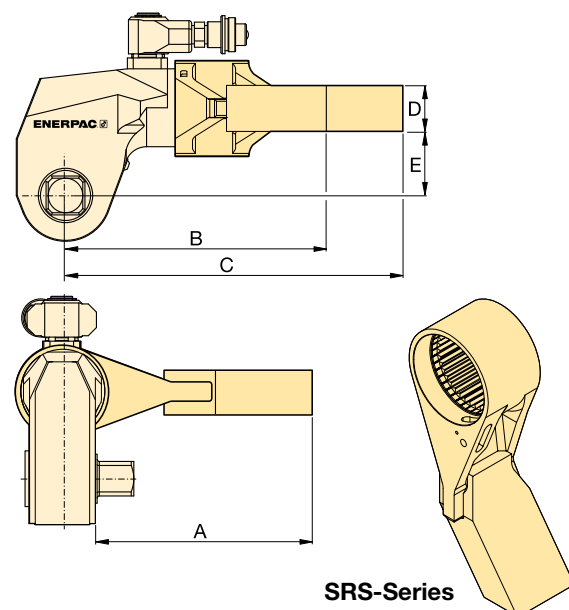

SRS-Series

For Wrench Model	Max. Torque (Nm)	Model Number	Dimensions (mm)					 (kg)*
			A	B	C	D	E	
S1500	1800	SRS151	97	87	128	24	34	0,8
	1640	SRS152	122	98	139	24	34	1,0
	1533	SRS153	147	109	150	24	34	1,2
S3000	3918	SRS301	111	104	170	34	48	1,6
	3712	SRS302	137	119	185	34	48	2,0
	3574	SRS303	162	133	200	34	48	2,5
S6000	7842	SRS601	148	134	198	39	62	2,3
	7454	SRS602	173	149	213	39	62	2,7
	7175	SRS603	198	163	228	39	62	3,4
S11000	14650	SRS1101	151	158	233	46	76	4,4
	13957	SRS1102	176	173	248	46	76	5,1
	13391	SRS1103	201	187	262	46	76	5,8
S25000	33538	SRS2501	183	225	314	50	100	7,6
	32049	SRS2502	208	240	329	50	100	8,4
	30750	SRS2503	233	254	344	50	100	10,0

* Weights indicated are for the accessories only and do not include the wrench.