

ADJUSTABLE AIRMOVERS

In some applications, the engineer must be able to vary the volume of outlet air. Brauer adjustable airmovers incorporate air gaps which are not fixed, instead the gap can be varied by loosening the knurled ring and adjusting the sleeve accordingly. The result is that air consumption can be minimised and output volumes varied from a light blow to a blast of high volume air. When the desired air flows are obtained, the knurled ring can be locked into position. In most instances, the ideal air gap will be between 0.05mm and 0.10mm (.002" to .004")

The Brauer standard range of adjustable airmovers are manufactured in our factory from aluminium. Stainless steel versions are also available when the application requires (see page 15)

Optional mounting rings and magnetic base are available (see page 22).

SOME TYPICAL APPLICATIONS – ADJUSTABLE AIRMOVERS



SCRAP REMOVAL ON TEXTILES

Two model AM10A airmovers used for fine adjustment of air flow which eliminate expensive vacuums and electric motors for trimming removal. Airmovers have the capability to remove the overheating problems inherent in electric motors.

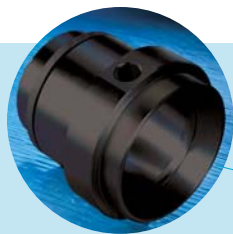
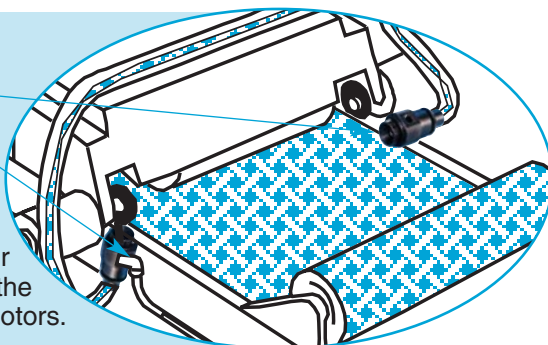

WOODWORKING - SAWDUST REMOVAL

AM60A airmovers used on this router eliminate the sawdust problem by boosting the vacuum system.

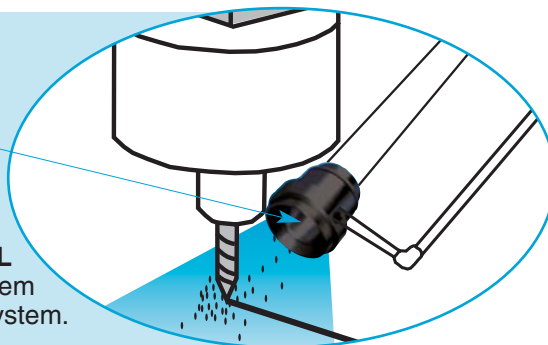

ADJUSTABLE AIRMOVER AM10A

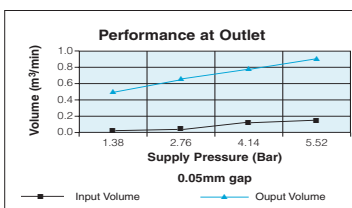
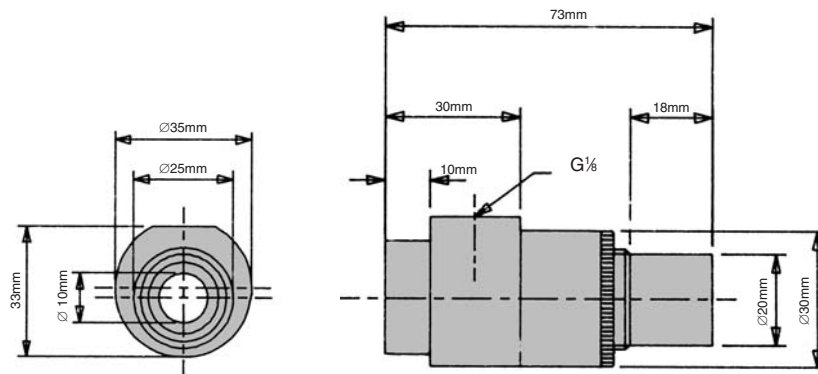

Bar	Vol in m³/min	Vol out m³/min
1.38	0.048	0.490
2.76	0.065	0.660
4.14	0.125	0.733
5.52	0.164	0.886



Material: Aluminium alloy.

Weight: 0.09Kg

Standard Gap: Adjustable

dB(A) at: 5.5 bar is 73

Shims: Not Applicable

Standard Inlet Thread: G $\frac{1}{8}$

Options: $\frac{1}{8}$ " NPT
Please specify on order $\frac{1}{8}$ " NPTF

PERFORMANCE DATA – DUCTED

METRIC		Back Pressure (mm water gauge) and guide to equivalent pipe length									
		125mm water gauge		250mm water gauge		375mm water gauge		500mm water gauge		625mm water gauge	
Supply Pressure kg/cm²	VI m³/min	Vo m³/min	Equiv. Pipe length m	Vo m³/min	Equiv. Pipe length m	Vo m³/min	Equiv. Pipe length m	Vo m³/min	Equiv. Pipe length m	Vo m³/min	Equiv. Pipe length m
2	.060	.26	7	.13	50	.20	37	.33	15	.13	—
3	.070	.47	2	.31	9	.36	10	.51	6	.37	14
4	.115	.64	1	.51	3	.54	4	.64	4	.58	6
5	.150	.76	1	.65	2	.72	3				
6	.180	.87	0.5	.78	2						

ADJUSTABLE AIRMOVER AM20A

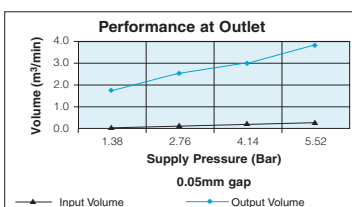
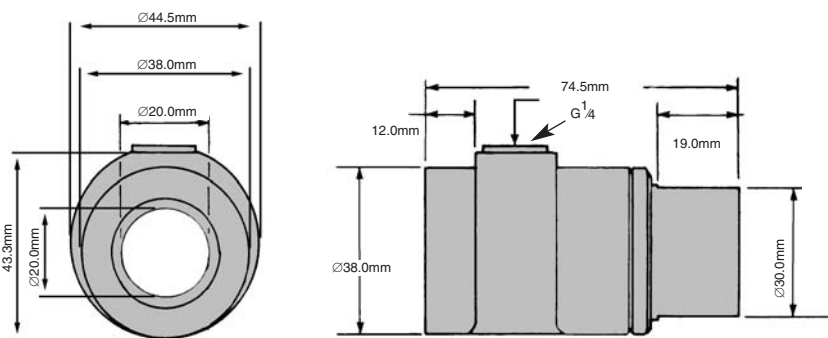

Bar	Vol in m³/min	Vol out m³/min
1.38	0.105	1.614
2.76	0.164	2.492
4.14	0.224	3.030
5.52	0.286	3.681



Material: Aluminium alloy.

Weight: 0.13Kg

Standard Gap: Adjustable

dB(A) at: 5.5 bar is 79

Shims: Not Applicable

Standard Inlet Thread: G $\frac{1}{4}$

Options: $\frac{1}{4}$ " NPT
Please specify on order $\frac{1}{4}$ " NPTF

PERFORMANCE DATA – DUCTED

METRIC		Back Pressure (mm water gauge) and guide to equivalent pipe length									
		50mm water gauge		100mm water gauge		150mm water gauge		200mm water gauge		250mm water gauge	
Supply Pressure kg/cm²	VI m³/min	Vo m³/min	Equiv. Pipe length m	Vo m³/min	Equiv. Pipe length m	Vo m³/min	Equiv. Pipe length m	Vo m³/min	Equiv. Pipe length m	Vo m³/min	Equiv. Pipe length m
2	.125	.91	2.0	.59	9	.42	7	.62	18	.74	16
3	.170	1.42	0.8	1.03	3	.85	7	1.05	6	1.22	6
4	.210	1.90	0.4	1.46	2	1.25	3	1.51	3	1.78	3
5	.265	2.55	0.3	1.98	1	1.70	2				
6	.295	3.45	0.2	2.75	0.5	2.18	1				

AM35A ADJUSTABLE AIRMOVER

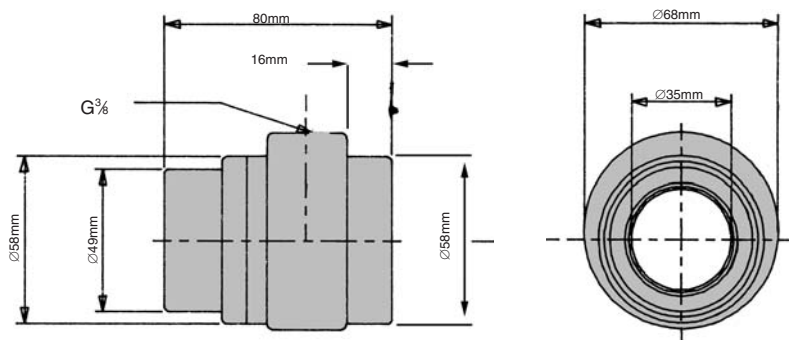

Material: Aluminium alloy.

Weight: 0.28Kg

Standard Gap: Adjustable

dB(A): 5.5 bar is 80

Shims: Not Applicable

Standard Inlet Thread: G³/₈

Options: $\frac{3}{8}$ " NPT
Please specify on order $\frac{3}{8}$ " NPTF

Bar	Vol in m ³ /min	Vol out m ³ /min
1.38	0.193	2.350
2.76	0.326	3.361
4.14	0.484	4.621
5.52	0.631	5.207

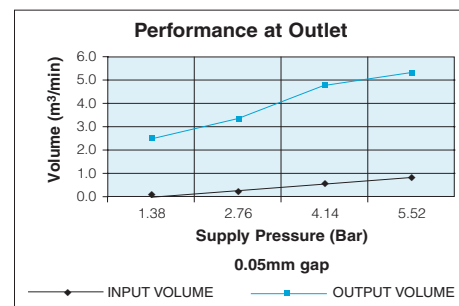

AM40A ADJUSTABLE AIRMOVER

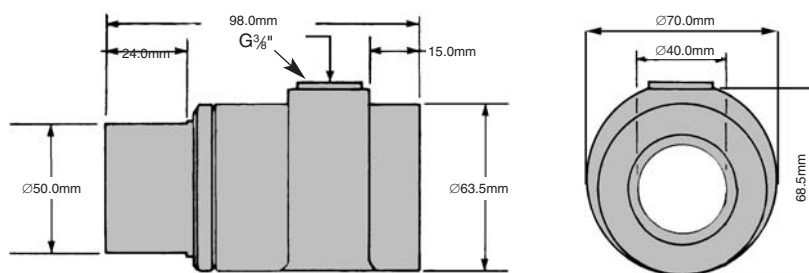

Bar	Vol in m ³ /min	Vol out m ³ /min
1.38	0.207	3.256
2.76	0.323	5.182
4.14	0.439	6.513
5.52	0.555	8.297

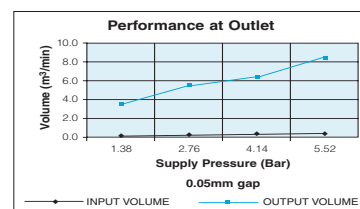

Material: Aluminium alloy.

Weight: 0.39Kg

Standard Gap: Adjustable

dB(A) at: 5.5 bar is 80

Shims: Not applicable

Standard Inlet Thread: G³/₈

Options: $\frac{3}{8}$ " NPT
Please specify on order $\frac{3}{8}$ " NPTF

PERFORMANCE DATA – DUCTED

METRIC	Back Pressure (mm water gauge) and guide to equivalent pipe length											
	50mm water gauge		100mm water gauge		150mm water gauge		200mm water gauge		250mm water gauge			
	Supply Pressure kg/cm ²	VI m ³ /min	Vc m ³ /min	Equiv. Pipe length m	Vo m ³ /min	Equiv. Pipe length m	Vc m ³ /min	Equiv. Pipe length m	Vo m ³ /min	Equiv. Pipe length m	Vc m ³ /min	Equiv. Pipe length m
2	.26	1.22	10	1.00	29							
3	.36	1.97	4	1.44	14	1.16	34	1.00	58			
4	.42	2.88	2	2.20	6	1.75	15					
5	.50	4.14	1	3.08	3	2.49	7	1.80	18	1.33	43	
6	.58	5.41	0.6	4.25	2	3.20	5	2.63	9	2.20	15	

ADJUSTABLE AIRMOVER AM60A

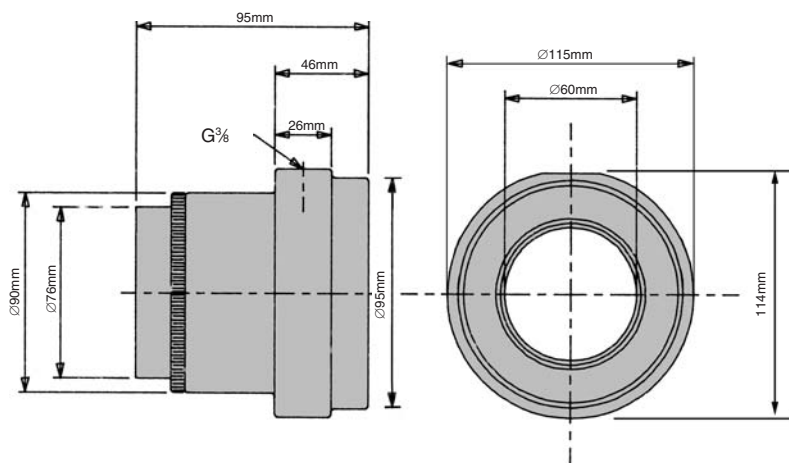

Material: Aluminium alloy.

Weight: 0.83Kg

Standard Gap: Adjustable

dB(A): 5.5 bar is 80

Shims: Not Applicable

Standard Inlet Thread: G $\frac{3}{8}$

Options: $\frac{3}{8}$ " NPT
Please specify on order $\frac{3}{8}$ " NPTF

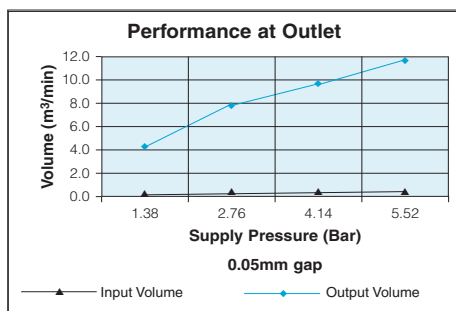

Bar	Vol in m³/min	Vol out m³/min
1.38	0.280	4.191
2.76	0.476	7.561
4.14	0.654	9.231
5.52	0.841	11.327

ADJUSTABLE AIRMOVER AM75A

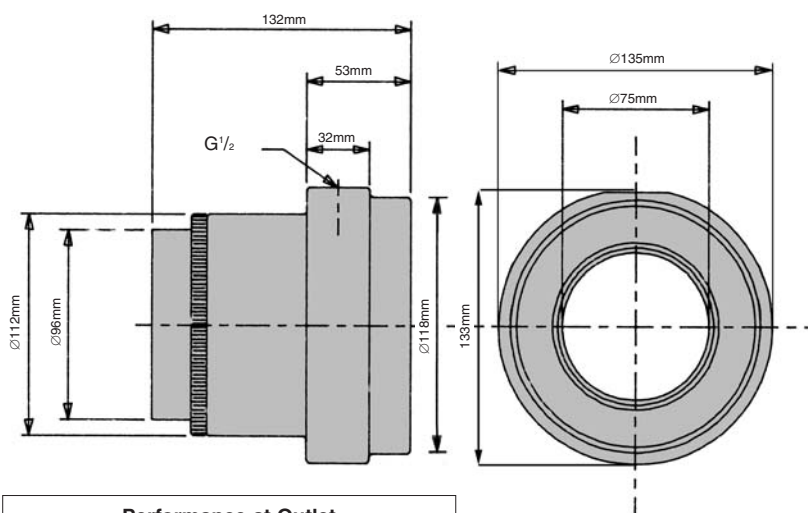

Material: Aluminium alloy.

Weight: 1.5Kg

Standard Gap: Adjustable

dB(A) at: 5.5 bar is 80

Shims: Not Applicable

Standard Inlet Thread: G $\frac{1}{2}$

Options: $\frac{1}{2}$ " NPT
Please specify on order $\frac{1}{2}$ " NPTF

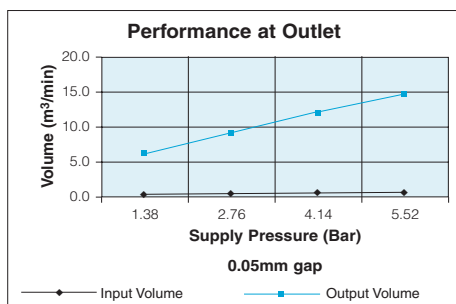

Bar	Vol in m³/min	Vol out m³/min
1.38	0.425	6.230
2.76	0.651	9.203
4.14	0.906	12.035
5.52	1.133	14.866

AM125A ADJUSTABLE AIRMOVER



Material: Aluminium Alloy.

Weight: 5.4Kg

Standard Gap: Adjustable

dB(A) at: 5.5 bar is 8.5

Shims: Not applicable

Standard Inlet Thread: $G\frac{3}{4}$

Options: $\frac{3}{4}$ " NPT
Please specify on order $\frac{3}{4}$ " NPTF

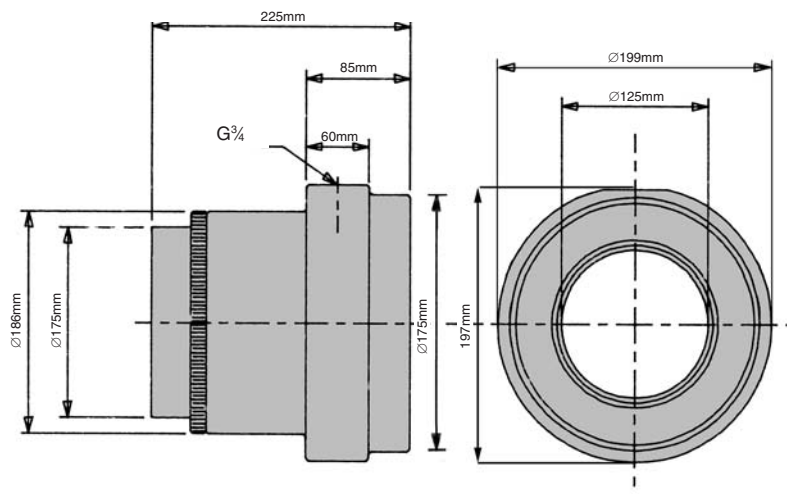

Bar	Vol in m ³ /min	Vol out m ³ /min
1.38	1.982	38.936
2.76	3.115	53.660
4.14	4.276	68.668
5.52	5.324	80.137

